



## ROTATORI IDRAULICI – HYDRAULIC ROTATORS

### VERSIONI FLANGIATE – FLANGED VERSION



FR 35 F



FR 50 F



FR 55 F

Modelli Models	Carico statico Static load	Carico dinamico Dynamic load	Peso Weight	Pressione Pressure	Rotazione Rotation	Coppia Torque	Portata Oil flow
	kg	kg	kg	bar		Nm	l/min
FR 35 F	3500	1750	22	250	360° cont.	900	20
FR 50 F	5000	2500	28	250	360° cont.	1100	20
FR 55 F	5500	2700	33	250	360° cont.	1300	20

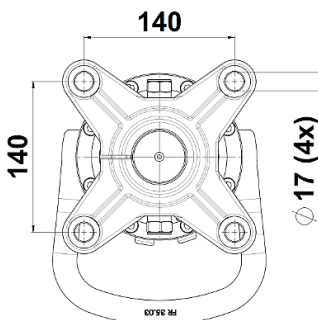
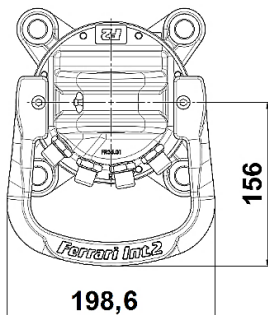
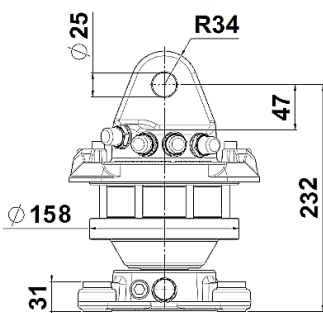

FR 35 F

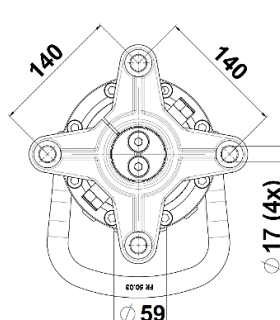
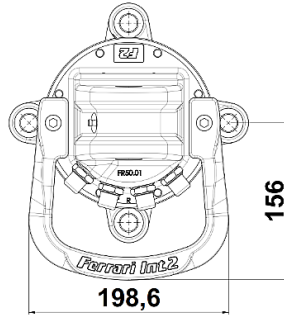
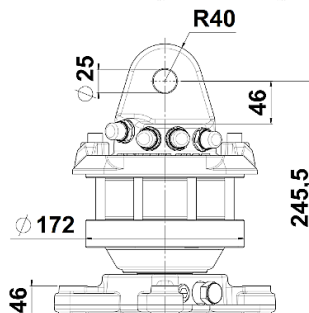

FR 50 F

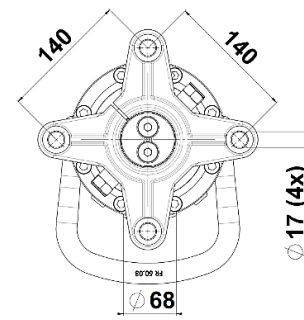
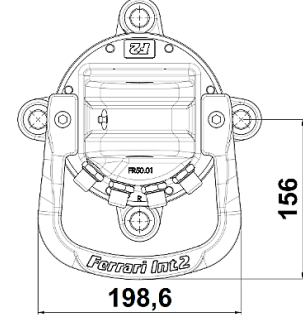
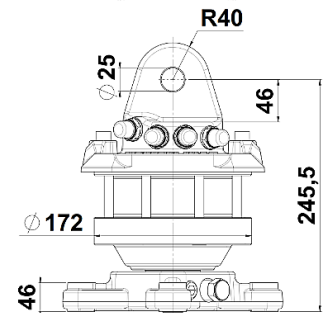

FR 55 F

I dati possono essere variati senza preavviso – Technical data can be revised without prior notice



## ROTATORI IDRAULICI – HYDRAULIC ROTATORS

### VERSIONI FLANGIATE – FLANGED VERSION



FR 75 DBX-F



FR 75 DBX-F/2



FR 125 DBX-F



FR 125 DBX-F/2

Modelli Models	Carico statico Static load	Carico dinamico Dinamic load	Peso Weight	Pressione Pressure	Rotazione Rotation	Coppia Torque	Portata Oil flow
	kg	kg	kg	bar		Nm	l/min
FR 75 DBX-F *	7000	3500	41	250	360° cont.	1900	25
FR 75 DBX-F/2 *	7000	3500	44	250	360° cont.	1900	25
FR 125 DBX-F *	12000	6000	56	250	360° cont.	2700	30
FR 125 DBX-F/2 *	12000	6000	59	250	360° cont.	2700	30

\* Doppio cuscinetto - Double bearing

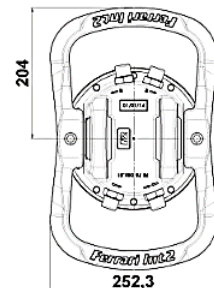
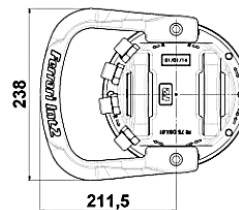
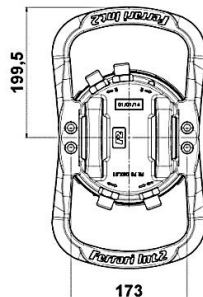
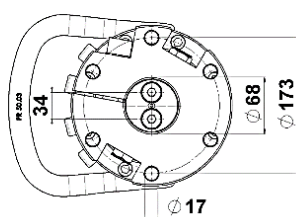
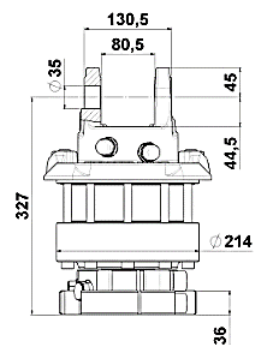
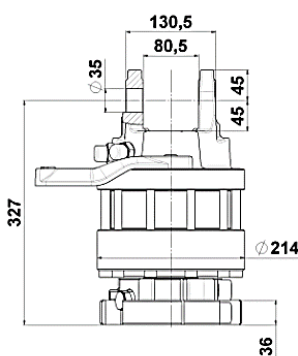
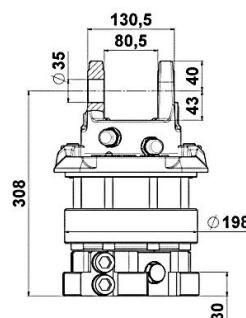
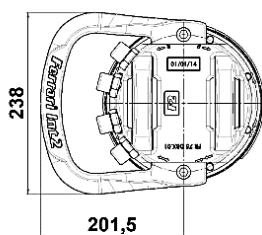
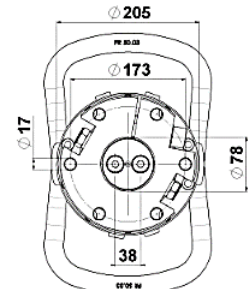
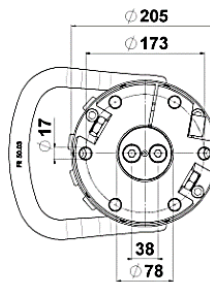
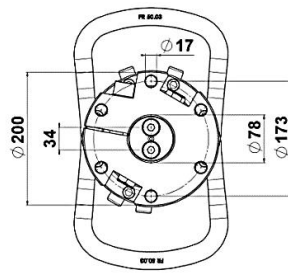
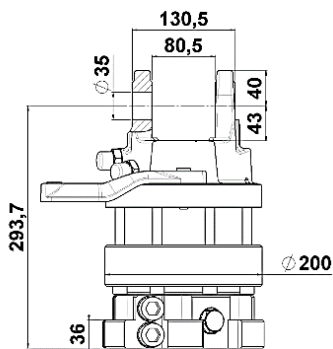

FR 75 DBX-F

FR 75 DBX-F/2

FR 125 DBX-F

FR 125 DBX-F/2

I dati possono essere variati senza preavviso – Technical data can be revised without prior notice



## ROTATORI IDRAULICI – HYDRAULIC ROTATORS

### VERSIONI FLANGIATE – FLANGED



FR 175 DBX-F



FR 125 F S6 DBX

Modelli Models	Carico statico Static load	Carico dinamico Dynamic load	Peso Weight	Pressione Pressure	Rotazione Rotation	Coppia Torque	Portata Oil flow
	kg	kg	kg	bar		Nm	l/min
FR 175 DBX-F *	17000	8500	70	250	360° cont.	3400	40
FR 125 F S6 DBX *	12000	6000	77	250	360° cont.	2900	35

\* Doppio cuscinetto - Double bearing

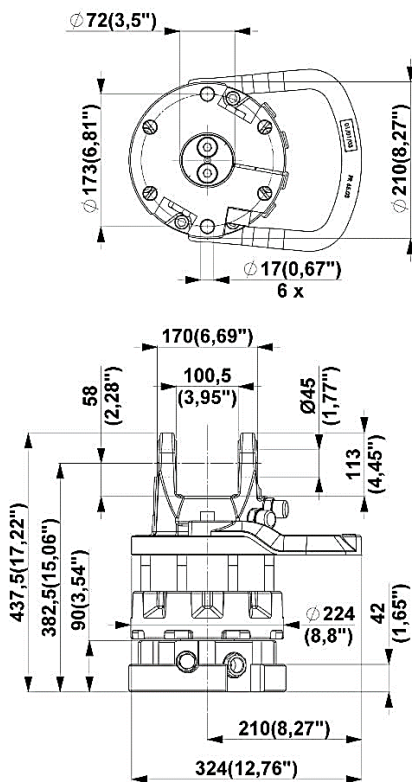

FR 175 DBX-F

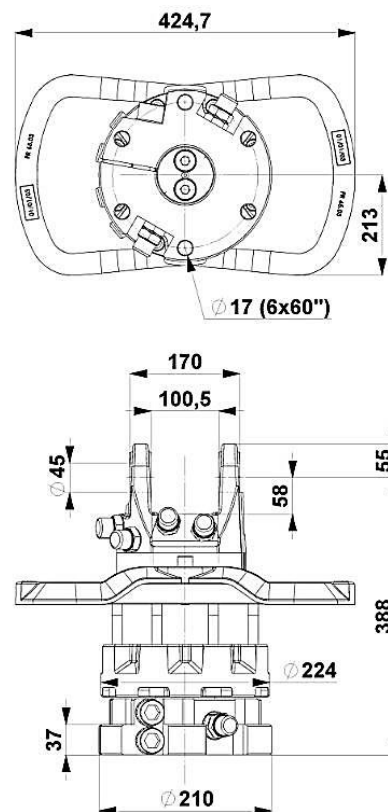

FR 125 F S6 DBX

I dati possono essere variati senza preavviso – Technical data can be revised without prior notice